

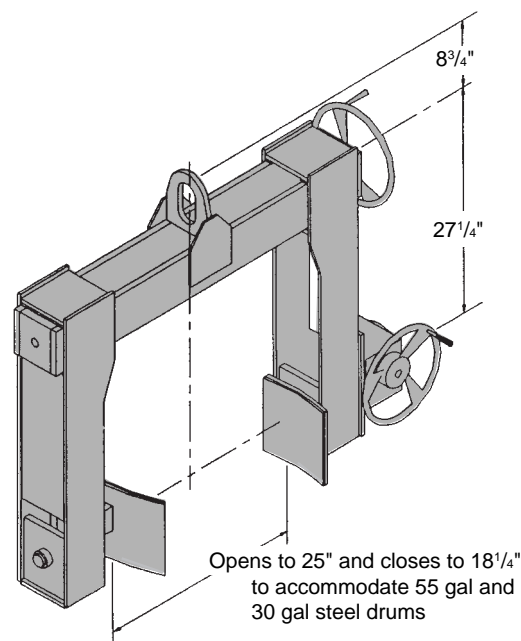

ROTATING DRUM LIFTERS

MODEL 738 ROTATING DRUM LIFTER



The model 738 rotating drum lifter provides improved safety and convenience. It is designed for lifting and rotating standard 30 and 55 gallon steel drums.

With this unit the drum is clamped onto the rotator by the action of the upper handwheel and a self-locking Acme screw and nut assembly. Once the drum is locked within the lifter arms it may be transported safely.

Turning the lower handwheel rotates the drum to pour the contents. Rotation is controlled by a self-locking worm and worm gear reducer that holds the drum in any desired position.

Optional features include air or electrically powered clamping and rotation. Please consult the factory with your specific requirements.

MODEL 738		
FULL DRUM CAPACITY	HALF DRUM CAPACITY	NET UNIT WEIGHT
1,000 lb.	500 lb.	500 lb.
2,000 lb.	1,000 lb.	575 lb.

PRODUCT SPECIFICATION CHART

For further information and pricing, please submit a certified dimension drawing of the drum. If a certified drawing is not available, complete the chart below.

DRUM DATA

- Standard 55 gal. steel drum _____
- Standard 21 1/2" OD fiber drum _____
- Weight of full drum _____ Lb.
- Non-standard drum:
- OD _____ In.
- Length _____ In.
- Type of drum _____ Steel
- _____ Fiber
- _____ Plastic
- _____ Other _____

HOIST HOOK DATA

- Dim. D _____ In.
- Dim. E _____ In.
- Dim. F _____ In.
- Dim. G _____ In.
- Dim. H _____ In.
- Dim. K _____ In.
- Dim. L _____ In.
- Capacity _____ Ton
- Mfr. _____

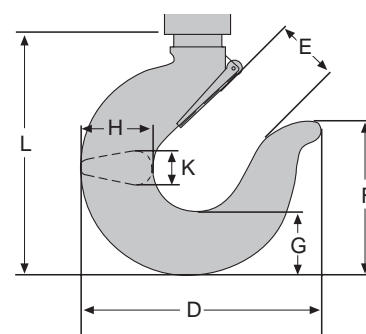

The descriptions and specifications contained in this manual were in effect at the time of printing. Bushman Equipment, Inc. reserves the right to change specifications and designs at any time without notice and without incurring any obligations.

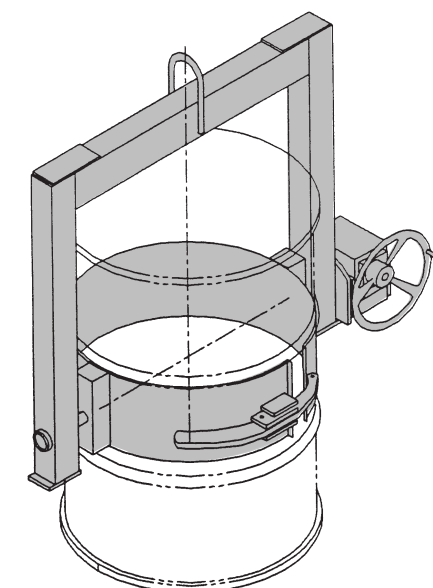

MODEL 770 ROTATING DRUM LIFTER

Model 770 rotating drum lifters enable the operator to pick up and move drums and dispense their contents accurately.

This model includes a quick release chain load binder that makes drum engagement and disengagement a simple procedure. The rotation mechanism is ergonomically designed and includes a self-locking gear reducer which is actuated by a handwheel.

A chainwheel option is available to permit rotation of the drum when the unit is beyond the operator's reach.

The standard model 770 is designed to work with 55 gallon drums. While these units can be modified to handle a variety of drum styles and sizes, they are not recommended for fiber or plastic drums. Consult the factory to discuss your specific requirements.

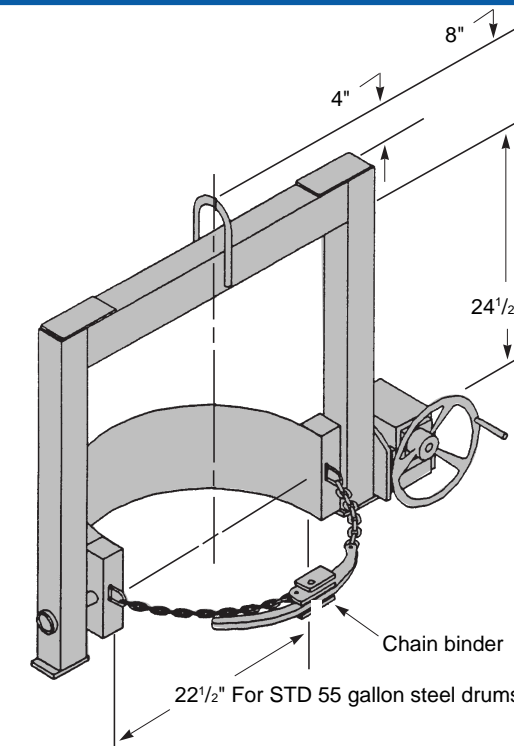

MODEL 770		
FULL DRUM CAPACITY	HALF DRUM CAPACITY	NET UNIT WEIGHT
1,000 lb.	500 lb.	195 lb.
2,000 lb.	1,000 lb.	230 lb.



MODEL 771 AND M771 ROTATING DRUM LIFTERS

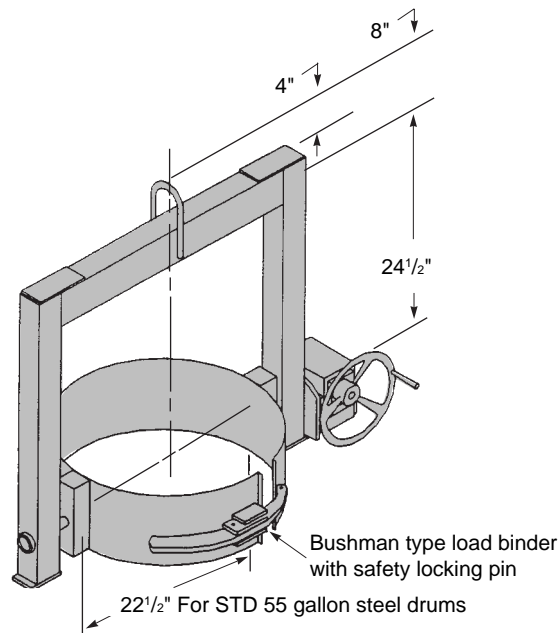

The model 771 is a heavy duty drum lifter designed to manipulate drums in high production areas.

While similar to the 770, this unit includes a solid steel band and lock mechanism in place of the chain load binder. The solid steel band helps maintain the integrity of the drum by increasing surface contact between the drum and the lifter. It also holds the drum more securely and provides greater control during pouring.

This model is equipped with an ergonomically designed rotation mechanism that is actuated by a handwheel with a self-locking gear reducer. A chain-wheel option is available to permit rotation of the drum when the unit is beyond the operator's reach.

The standard model 771 is designed for 55 gallon drums, but it can also be designed to work with a variety of different drum styles and sizes. Consult the factory for further information.

MODEL 771, MANUAL ROTATING DRUM LIFTER

FULL DRUM CAPACITY	HALF DRUM CAPACITY	NET UNIT WEIGHT
1,000 lb.	500 lb.	265 lb.
2,000 lb.	1,000 lb.	310 lb.

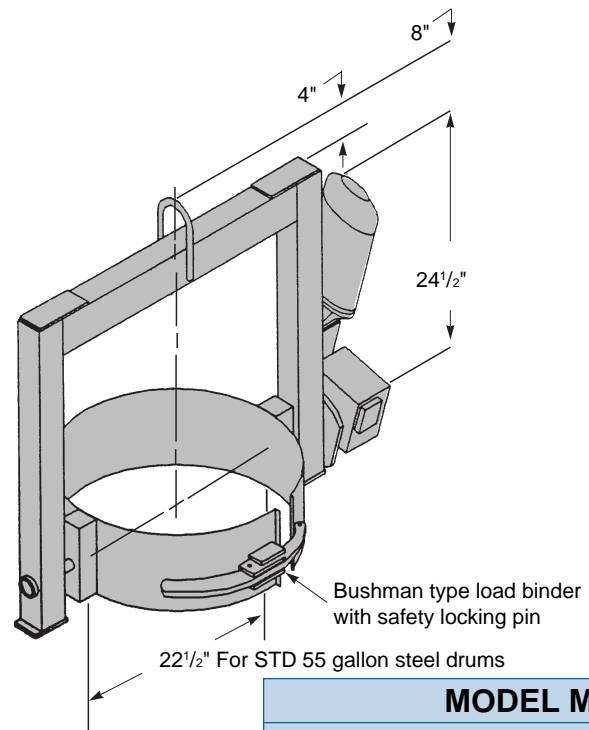

Motorized rotation is available with the model M771 drum lifter. This feature provides greater handling ease and more precise positioning for pouring and dumping. It is also an important safety feature since it frees the operator from the necessity of working in the immediate vicinity of the discharge operation.

Standard units are available with the following voltages: 230-460/3/60 and 110/1/60. Air operated versions are also available. Please consult the factory with your specific requirements.

MODEL M771, MOTORIZED ROTATING DRUM LIFTER

FULL DRUM CAPACITY	HALF DRUM CAPACITY	NET UNIT WEIGHT
1,000 lb.	500 lb.	500 lb.
2,000 lb.	1,000 lb.	595 lb.

All Bushman drum handling equipment is designed to meet or exceed the requirements of ASME-ANSI Standard B30.20.

MODEL 775 AND M775 ROTATING DRUM LIFTERS

The model 775 rotating drum lifter employs a cradle assembly to support the weight of the drum. Two chain binder assemblies, in conjunction with an adjustable vertical lock mechanism, hold the drum in the basket during rotation. This design permits the unit to hold the drum securely and ensures precise positioning without relying on a pressurized clamping or engagement mechanism.

Model 775 lifters accommodate a variety of drum sizes and styles, including plastic and fiber drums.

The model 775 is particularly useful when handling drums that are damaged or that cannot withstand high compression engagement. This model should be chosen whenever the outside surface of the drum will not permit proper engagement by clamping alone.

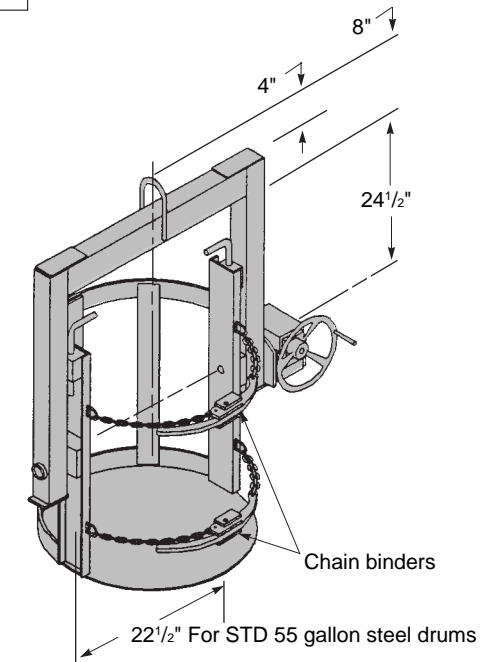

MODEL 775, MANUAL ROTATING DRUM LIFTER

FULL DRUM CAPACITY	HALF DRUM CAPACITY	NET UNIT WEIGHT
1,000 LB.	500 LB.	285 LB.
2,000 LB.	1,000 LB.	380 LB.

Motorized rotation is available with the model M 775 drum lifter. This feature provides greater handling ease and more precise positioning for pouring and dumping. It is also an important safety feature since it frees the operator from the necessity of working in the immediate vicinity of the dumping operation.

Standard units are available with the following voltages: 230-460/3/60 and 110/1/60. Air operated versions are also available. Please consult the factory with your specific requirements.

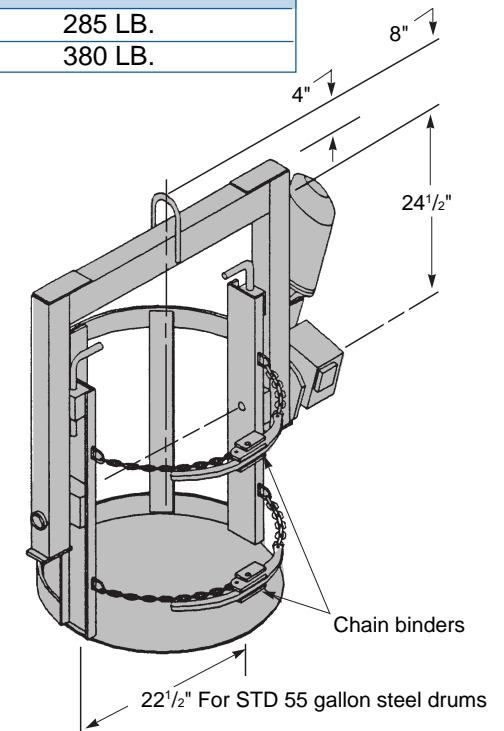

MODEL M775, MOTORIZED ROTATING DRUM LIFTER

FULL DRUM CAPACITY	HALF DRUM CAPACITY	NET UNIT WEIGHT
1,000 lb.	500 lb.	685 lb.
2,000 lb.	1,000 lb.	800 lb.

Authorized Sales & Service
J. HERBERT CORPORATION
 Call 1-800-255-0588
 407-846-0588 Fax: 846-1066
 info@jherbertcorp.com

Visit us online:
www.jherbertcorp.com

Custom Designed Material Handling Solutions

BUSHMAN
 EQUIPMENT, INC.®

P.O. Box 309 • Butler, WI 53007-0309
 262-790-4200 • Fax 262-790-4202
 E-Mail: custinfo@bushman.com • www.bushman.com