

NEW!

Fulcrum Winch Series

5300 to 45600 lb (2409 to 20727 kg) capacity



The new Fulcrum “E” series electric winches are designed to meet or exceed North American ANSI / ASME B30.7 standards while providing optimum performance in a rugged, safe, and versatile package.

IR has combined over 70 years of electric winch manufacturing experience with input from a diverse group of endusers, riggers, and regulatory officials, to determine the design criteria for the new Fulcrum series of winches. Based on industry requirements to maximize safety, versatility, and reliability the Fulcrum “E” series is available in two basic configurations: “EP” for pulling applications, and “EL” for lifting applications. An extensive array of options further enhances the Fulcrum’s flexibility while its 5:1 design factor and **two year warranty** is your assurance of safe, dependable operation for the most demanding applications worldwide.



EP45600 (20 ton Electric Fulcrum Winch)

n Standard features

- Meets or exceeds ANSI / ASME B30.7
- Lifting models with 18:1 D/d ratio (per ANSI / ASME B30.7)
- Pulling models with 15:1 D/d ratio (per ANSI / ASME B30.7)
- 5:1 design factor
- Winch motors are high torque design, rated for continuous duty totally enclosed fan cooled (TEFC)
- All worldwide voltages
- Wide selection of standard gear ratios and line speeds
- Automatic motor disc brake
- Fully enclosed, 95% efficient, planetary gear boxes
- Underwound or overwound cable take-offs
- Variable mounting configurations (inverted, side, etc.)
- **Two year warranty**
- Hydraulic and Man Rider™ models available on request

Specifications:

for pulling winches at 15:1 D/d ratio

Frame	Rope size		Winch 1st layer rated load		Drum diameter		Flange diameter		Std. drum length		No. of layers	Capacity std. drum		Standard min. drum length		Standard max. ¹ drum length	
	in.	mm	lbs	kg	in.	mm	in.	mm	in.	mm		ft	m	in.	mm	in.	mm
3	1/2	13	5300	2409	8.625	219	17	432	18	457	7	768	234	18	457	42	1067 ¹
3	9/16	14	6700	3045	8.625	219	17	432	18	457	6	577	176	18	457	42	1067 ¹
4	5/8	16	8200	3727	10.750	273	22	559	24	610	8	1216	371	18	457	48	1219
4	3/4	19	11700	5318	10.750	273	22	559	24	610	7	896	273	18	457	48	1219
5	7/8	22	15900	7227	14.000	356	28	711	24	610	7	962	293	18	457	48	1219
5	1	25.4	20600	9364	14.000	356	28	711	24	610	6	713	217	18	457	48	1219
6	1 1/8	29	26000	11818	16.000	406	34	864	24	610	7	877	267	18	457	48	1219
7	1 1/4	32	31900	14500	20.000	508	38	965	24	610	7	946	288	18	457	48	1219
7	1 3/8	35	38400	17455	20.000	508	38	965	24	610	6	721	220	18	457	48	1219
8	1 1/2	38	45600	20727	24.000	610	45	1143	30	762	6	974	297	24	610	60	1524

for lifting winches at 18:1 D/d ratio

Frame	Rope size		Winch 1st layer rated load		Drum diameter		Flange diameter		Std. drum length		No. of layers	Capacity std. drum		Standard min. drum length		Standard max. drum length	
	in.	mm	lbs	kg	in.	mm	in.	mm	in.	mm		ft	m	in.	mm	in.	mm
3	1/2	13	5300	2409	8.625	219	17	432	18	457	7	768	234	18	457	42	1067 ¹
3	9/16	14	6000	2722	9.750	248	17	432	18	457	5	505	154	18	457	42	1067 ¹
4	5/8	16	8200	3727	10.750	273	22	559	24	610	8	1216	371	18	457	48	1219
4	3/4	19	9200	4181	14.000	356	22	559	24	610	4	548	167	18	457	48	1219
5	7/8	22	14100	6409	16.000	406	28	711	24	610	6	873	266	18	457	48	1219
5	1	25.4	16400	7455	18.000	457	28	711	24	610	4	526	160	18	457	48	1219
6	1 1/8	29	21300	9682	20.000	508	34	864	24	610	6	845	258	18	457	48	1219
7	1 1/4	32	27000	12273	24.000	610	38	965	24	610	5	715	218	18	457	48	1219
7	1 3/8	35	32600	14818	24.000	610	38	965	24	610	4	505	154	18	457	48	1219
8	1 1/2	38	42400	19273	26.000	660	45	1143	30	762	6	1033	315	24	610	60	1524

¹ For drum layers longer than standard contact Technical Sales

NEW!

Fulcrum Winch

200 to 50000 lb (91 to 22680 kg) capacity



Specifications:

Rope size in. mm	Pulling winches, 1st layer rated load line speed				Lifting winches, 1st layer rated load line speed				
	lbs	kg	fpm	m/min	lbs	kg	fpm	m/min	
Frame 3									
1/2 13	5300	2409	18	5.5	5300	2409	18	5.5	
1/2 13	5300	2409	28	8.5	5300	2409	28	8.5	
1/2 13	5300	2409	39	11.9	5300	2409	39	11.9	
1/2 13	5300	2409	59	18.0	5300	2409	59	18.0	
1/2 13	5300	2409	86	26.2	5300	2409	86	26.2	
1/2 13	5300	2409	101	30.8	5300	2409	101	30.8	
9/16 14	6700	3045	23	7.0	6000	2727	25	7.6	
9/16 14	6700	3045	34	10.4	6000	2727	38	11.6	
9/16 14	6700	3045	48	14.6	6000	2727	53	16.2	
9/16 14	6700	3045	69	21.0	6000	2727	77	23.5	
9/16 14	6700	3045	87	26.5	6000	2727	97	29.6	
9/16 14	6700	3045	102	31.1	6000	2727	114	34.7	
Frame 4									
5/8 16	8200	3727	11	3.4	8200	3727	11	3.4	
5/8 16	8200	3727	19	5.8	8200	3727	19	5.8	
5/8 16	8200	3727	24	7.3	8200	3727	24	7.3	
5/8 16	8200	3727	38	11.6	8200	3727	38	11.6	
5/8 16	8200	3727	54	16.5	8200	3727	54	16.5	
5/8 16	8200	3727	79	24.1	8200	3727	79	24.1	
5/8 16	8200	3727	99	30.2	8200	3727	99	30.2	
5/8 16	8200	3727	117	35.7	8200	3727	117	35.7	
3/4 19	11700	5318	14	4.3	9200	4181	18	5.5	
3/4 19	11700	5318	20	6.1	9200	4181	25	7.6	
3/4 19	11700	5318	25	7.6	9200	4181	31	9.5	
3/4 19	11700	5318	46	14.0	9200	4181	58	17.7	
3/4 19	11700	5318	55	16.8	9200	4181	70	21.3	
3/4 19	11700	5318	64	19.5	9200	4181	81	24.7	
3/4 19	11700	5318	81	24.7	9200	4181	103	31.4	
3/4 19	11700	5318	101	30.8	9200	4181	128	39.0	

Specifications:

Rope size in. mm	Pulling winches, 1st layer rated load line speed				Lifting winches, 1st layer rated load line speed				
	lbs	kg	fpm	m/min	lbs	kg	fpm	m/min	
Frame 5									
7/8 22	15900	7227	21	6.4	14100	6409	23	7.0	
7/8 22	15900	7227	29	8.8	14100	6409	32	10.0	
7/8 22	15900	7227	36	11.0	14100	6409	40	12.2	
7/8 22	15900	7227	82	25.0	14100	6409	92	28.0	
1 25.4	20600	9364	21	6.4	16400	7455	26	7.9	
1 25.4	20600	9364	25	7.6	16400	7455	31	9.5	
1 25.4	20600	9364	29	8.8	16400	7455	36	11.0	
1 25.4	20600	9364	36	11.0	16400	7455	46	14.0	
Frame 6									
1 1/8 29	26000	11818	18	5.5	21300	9682	22	6.7	
1 1/8 29	26000	11818	26	7.9	21300	9682	32	10.0	
1 1/8 29	26000	11818	38	11.6	21300	9682	47	14.3	
1 1/8 29	26000	11818	75	22.9	21300	9682	91	27.7	
1 1/8 29	26000	11818	90	27.4	21300	9682	110	33.5	
Frame 7									
1 1/4 32	31900	14500	21	6.4	27000	12273	24	7.3	
1 1/4 32	31900	14500	26	7.9	27000	12273	31	9.5	
1 1/4 32	31900	14500	34	10.4	27000	12273	40	12.2	
1 1/4 32	31900	14500	43	13.1	27000	12273	51	15.5	
1 1/4 32	31900	14500	50	15.2	27000	12273	59	18.0	
1 3/8 35	38400	17454	22	6.7	32600	14818	25	7.6	
1 3/8 35	38400	17454	25	7.6	32600	14818	29	8.8	
1 3/8 35	38400	17454	35	10.7	32600	14818	41	12.5	
1 3/8 35	38400	17454	43	13.1	32600	14818	51	15.5	
1 3/8 35	38400	17454	51	15.5	32600	14818	60	18.3	
Frame 8									
1 1/2 38	45600	20727	21	6.4	42400	19273	23	7.0	
1 1/2 38	45600	20727	31	9.5	42400	19273	33	10.1	
1 1/2 38	45600	20727	37	11.3	42400	19273	39	11.9	
1 1/2 38	45600	20727	47	14.3	42400	19273	50	15.2	

Drum Lengths

Models		Standard Drum Length		Optional Drum length			
Pulling	Lifting	in.	mm	in.	mm	in.	mm
Frame 3							
EP5300	EL5300	18	457	30	762	42	1069
EP6700	EL6000	18	457	30	762	42	1069
Frame 4							
EP8200	EL8200	24	610	36	914	48	1219
EP11700	EL9200	24	610	36	914	48	1219
Frame 5							
EP15900	EL14100	24	610	36	914	48	1219
EP20600	EL16400	24	610	36	914	48	1219
Frame 6							
EP26000	EL21300	24	610	36	914	48	1219
Frame 7							
EP31900	EL27000	24	610	36	914	48	1219
EP38400	EL32600	24	610	36	914	48	1219
Frame 8							
EP45600	EL42400	30	762	42	1069	54	1372

NEW!

Fulcrum Winch

200 to 50000 lb (91 to 22680 kg) capacity



Dimensions ¹

Pulling

Frame	Model	A		B		C		D		E		F		G		H		J	
		in.	mm	in.	mm	in.	mm	in.	mm	in.	mm	in.	mm	in.	mm	in.	mm	in.	mm
3	EP5300-18-18	18	457	8.63	219	4.19	106	17	432	23.5	597	29.54	737	0.5	13	23	584	15	381
3	EP6700-23-18	18	457	8.63	219	4.19	106	17	432	23.5	597	29.54	737	0.5	13	23	584	15	381
4	EP8200-19-24	24	610	10.75	273	5.63	143	22	559	28.5	711	40.54	1030	0.5	13	27.5	699	17.5	445
4	EP11700-14-24	24	610	10.75	273	5.63	143	22	559	28.5	711	40.54	1030	0.5	13	27.5	699	17.5	445
5	EP15900-21-24	24	610	14	357	7	178	28	711	33.5	851	42.5	1080	0.5	13	34.5	876	22.5	572
5	EP20600-21-24	24	610	14	357	7	178	28	711	33.5	851	42.5	1080	0.5	13	34.5	876	22.5	572
6	EP26000-18-24	24	610	16	406	9	229	34	864	42.5	1080	44.82	1138	0.5	13	38.5	978	25.5	648
7	EP31900-21-24	24	610	20	508	9	229	38	965	-	-	-	-	-	-	-	-	-	
7	EP38400-25-24	24	610	20	508	9	229	38	965	-	-	-	-	-	-	-	-	-	
8	EP45600-21-30	30	762	24	610	10.5	267	45	1143	-	-	-	-	-	-	-	-	-	

¹ Dimensions are subject to change. Contact technical sales for certified prints.
Dimensions are for standard base models only.

Dimensions ¹

Lifting

Frame	Model	A		B1		C		D		E		F		G		H		J	
		in.	mm	in.	mm	in.	mm	in.	mm	in.	mm	in.	mm	in.	mm	in.	mm	in.	mm
3	EL5300-18-18	18	457	8.63	219	4.19	106	17	432	23.5	597	29.54	737	0.5	13	23	584	15	381
3	EL6700-23-18	18	457	9.75	248	3.63	92	17	432	23.5	597	29.54	737	0.5	13	23	584	15	381
4	EL8200-19-24	24	610	10.75	273	5.63	143	22	559	28.5	711	40.54	1030	0.5	13	27.5	699	17.5	445
4	EL9200-18-24	24	610	14	357	4	102	22	559	28.5	711	40.54	1030	0.5	13	27.5	699	17.5	445
5	EL14100-23-24	24	610	16	406	6	152	28	711	33.5	851	42.5	1080	0.5	13	34.5	876	22.5	572
5	EL16400-26-24	24	610	18	457	5	127	28	711	33.5	851	42.5	1080	0.5	13	34.5	876	22.5	572
6	EL21300-22-24	24	610	20	508	7	179	34	864	42.5	1080	44.82	1138	0.5	13	38.5	978	25.5	648
7	EL27000-24-24	24	610	24	610	7	179	38	965	-	-	-	-	-	-	-	-	-	
7	EL32600-29-24	24	610	24	610	7	179	38	965	-	-	-	-	-	-	-	-	-	
8	EL42400-23-30	30	762	26	660	9.5	241	45	1143	-	-	-	-	-	-	-	-	-	

¹ Dimensions are subject to change. Contact technical sales for certified prints.
Dimensions are for standard base models only.

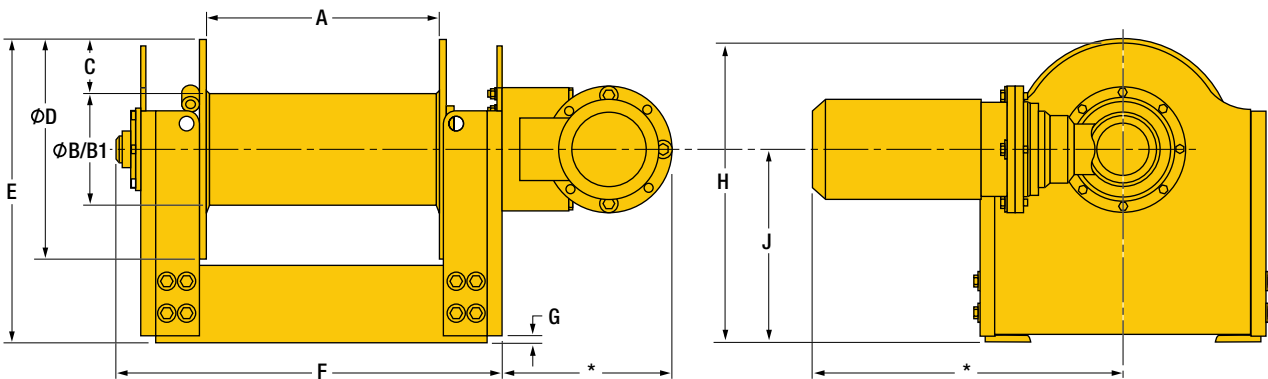

NEW!

Fulcrum Winch

200 to 50000 lb (91 to 22680 kg) capacity



How to Order:

Specify the complete model as shown. **Example: EL5300-28-18-8G-M4-P4-20** is an electric powered lifting winch with a 5300 lb capacity, a 28 fpm line speed, an 18 inch drum, 460-3-60 volt, with grooved drum, NEMA 4 starter and pushbutton, and 20 feet of control cord.

Series	Application	Capacity	Line speed	Drum length	Voltage	Winch options	Starter/drives	Control station	Cord length (ft)
E	L	5300	28	18	8	G	M4	P4	20
E = Electric H = Hydraulic ³	L = Lifting P = Pulling MR = Electric Manrider ³	(See table below)	(See table below)	(See std. drum width chart below)	1 = 115-1-60 2 = 230-1-60 3 = 208-3-60 4 = 230-3-60 5 = 380-3-50 6 = 400-3-50 7 = 415-3-50 8 = 460-3-60 9 = 575-3-60 0 = Used w/hydraulic and air units	A = Air operated drum brake C = Special motor per customer specs D = Drum divider flange; X = no. of dividers F = Free-spooling clutch G = Grooved drum ⁽³⁾ H = Horizontal load reversing drum ⁽⁴⁾ J = Space heater in motor K = Hand crank for emergency manual operation L = Drum locking pin M = Marine duty, IEEEE45 motor N = Mirror image unit P = Marine 812 finish Q = Special paint; please specify R = Press roller on drum S = NEMA 4 upper & lower, rotary limit switch T = Dual speed motor U = Manual level wind W = Slack rope detector X = Drum guard Y = Electronic overload limiter Z = Sandblast / carbozinc	M4 = NEMA 4 starter M4X = NEMA 4X starter V = Variable frequency drive. Customer to specify control requirements. X = Explosion-proof starter. Customer to specify class, division and group.	D1 = Drum switch NEMA 1 D4 = Drum switch NEMA 4 E = Explosion-proof controller. Customer to specify class, division and group. P4 = Pushbutton NEMA 4 P4X = Pushbutton NEMA 4X W1 = Wall mount pushbutton station, NEMA 1 W4 = Wall mount pushbutton station, NEMA 4	

First layer capacities

Frame	Pulling capacities	Line speeds / fpm ⁽¹⁾	Lifting capacities	Line speeds / fpm ⁽¹⁾	Std. drum width ⁽²⁾
3	EP 5300 lbs / 2409 kg	18, 28, 39, 59, 86, 101	EL 5300 lbs / 2409 kg	18, 28, 39, 59, 86, 101	18 in. / 457 mm
3	EP 6700 lbs / 3045 kg	23, 34, 48, 69, 87, 102	EL 6000 lbs / 2727 kg	25, 38, 53, 77, 97, 114	18 in. / 457 mm
4	EP 8200 lbs / 3727 kg	11, 19, 24, 38, 54, 79, 99, 117	EL 8200 lbs / 3727 kg	11, 19, 24, 38, 54, 79, 99, 117	24 in. / 610 mm
4	EP 11700 lbs / 5318 kg	14, 20, 25, 46, 55, 64, 81, 101	EL 9200 lbs / 4181 kg	18, 25, 31, 58, 70, 81, 103, 128	24 in. / 610 mm
5	EP 15900 lbs / 7227 kg	21, 29, 36, 82	EL 14100 lbs / 6409 kg	23, 32, 40, 92	24 in. / 610 mm
5	EP 20600 lbs / 9364 kg	21, 25, 29, 36	EL 16400 lbs / 7455 kg	26, 31, 36, 46	24 in. / 610 mm
6	EP 26000 lbs / 11818 kg	18, 26, 38, 75, 90	EL 21300 lbs / 9682 kg	22, 32, 47, 91, 110	24 in. / 610 mm
7	EP 31900 lbs / 14500 kg	21, 26, 34, 43, 50	EL 27000 lbs / 12273 kg	24, 31, 40, 51, 59	24 in. / 610 mm
7	EP 38400 lbs / 17455 kg	22, 25, 35, 43, 51	EL 32600 lbs / 14818 kg	25, 29, 41, 51, 60	24 in. / 610 mm
8	EP 45600 lbs / 20727 kg	21, 31, 37, 47	EL 42400 lbs / 19273 kg	23, 33, 39, 50	30 in. / 762 mm

- (1) First layer line speed
- (2) Other drum lengths available
- (3) Grooving is based on left hand spiral for overwind take-off. The size of the grooving is based on the recommended wire rope size specified for each frame and is selected to meet ANSI / ASME B30.7 recommendations. If different size grooving is required it must be specified by enduser at time of order.
- (4) Wire rope size and cable take-offs must be specified at time of an order.

Authorized Sales & Service
J. HERBERT CORPORATION
 Call 1-800-255-0588
 407-846-0588 Fax: 846-1066
 info@jherbertcorp.com

Visit us online:
www.jherbertcorp.com