

For Lifting or Pulling Applications

G Series Ratchet Lever Hoists



3/4 - 15 Ton
Made in USA

COFFING G Series Model - Malleable iron roller chain ratchet lever hoists are efficient and durable. Roller chain can be spliced to create longer lifts and can handle higher capacities than coil chain. G Series hoists are ideal for utility transmission and distribution work.

- **CAPACITIES & LIFT** - Rated loads from 3/4 to 15 Tons. For standard lift, see chart below. Other lifts available.
- **RUGGED** - Unit and handle made from malleable iron. Riveted construction makes the unit tamper-resistant.
- **FREE CHAINING** - Free chaining mechanism allows quick and easy take-up and positioning of slack chain. Hoist will not free chain when under load.
- **HANDLE STOPS** - Prevent handle from spinning if it is accidentally released by the operator.
- **SINGLE OR DOUBLE LOCKING PAWL DESIGN** - See page 37.
- **MULTIPLE RIGGING OPTIONS** - Hoist can lift, pull, or bind. Can be operated from either side and will work in any position with equal efficiency.
- **SNAP HOOK AND LINK** - Allows operator to convert unit to next smaller capacity to give longer lift and faster operation. Snap hook acts as an end stop and will not pass through chain sprocket.
- **OPTIONS** - Bullard hooks, bronze hooks, and zinc-plated hooks - consult factory.
- **LIFETIME WARRANTY**

S P E C I F I C A T I O N S

G Series Ratchet Lever Hoists

Capacity		Model Number †	Standard Lift (In.)	Strands of Load Chain	Minimum Dist. Between Hooks (In.)	Handle Length (In.)	Minimum Increment (In.) †	Average Handle Effort (lbs.)	Net Weight (Lbs.)
Lbs.	Tons								
1500	3/4	AG/AGI	56 1/2	1	13	18 3/4	.624/.313	56	14
3000	1 1/2	ATG/ATGI	57	2	15	18 3/4	.313/.156	60	17
3000	1 1/2	FG/FGI	56 1/2	1	16	27 5/8	1.000/.500	116	25
6000	3	FTG/FTGI	57	2	17 5/8	27 5/8	.500/.250	120	34
9000	4 1/2	ZG-4 1/2	53	3	25	33 5/8	.333	124	49
12000	6	ZG-6	53	4	25	33 5/8	.250	124	59
18000	9	WG-9	60	5	30	33 5/8	.200	124	120
22000	11	WG-11	60	6	30	33 5/8	.167	124	130
26000	13	WG-13	60	7	30	33 5/8	.143	124	140
30000	15	WG-15	60	8	30	33 5/8	.125	124	150

† First designation is single pawl model and second "I" designation is double pawl model.

NOTE: For complete dimensional data, refer to Coffing Dimensional Databook.

G Series 3/4 - 15 Ton

Authorized Sales & Service
J. HERBERT CORPORATION
Call 1-800-255-0588
407-846-0588 Fax: 846-1066
info@jherbertcorp.com

Visit us online:
www.jherbertcorp.com

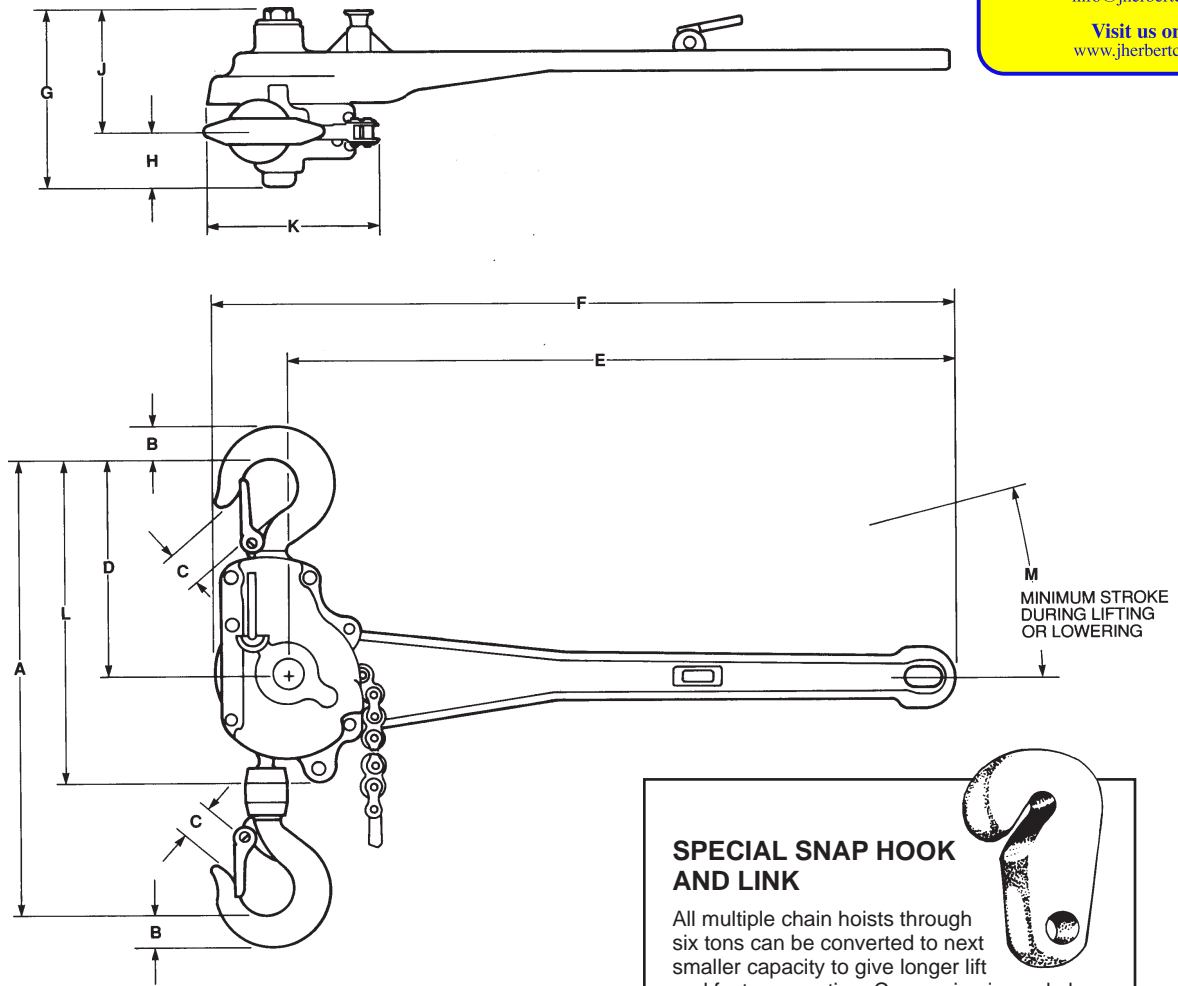

SPECIAL SNAP HOOK AND LINK

All multiple chain hoists through six tons can be converted to next smaller capacity to give longer lift and faster operation. Conversion is made by simply unhooking the special snap hook at the end of the chain. The snap hook acts as a lug and will not pass through the chain sprocket.

Dimensions

Model Number	A	B	C*	D	E	F	G	H	J	K	L	M
AG	13	1	1	6 ¹ / ₄	18 ³ / ₄	20 ³ / ₄	5	1 ¹ / ₂	3 ¹ / ₂	4 ¹ / ₂	9 ¹ / ₄	60°
AGI ¹	13	1	1	6 ¹ / ₄	18 ³ / ₄	20 ³ / ₄	5	1 ¹ / ₂	3 ¹ / ₂	4 ¹ / ₂	9 ¹ / ₄	30°
ATG ²	15	1	1	6 ¹ / ₄	18 ³ / ₄	20 ³ / ₄	5	1 ¹ / ₂	3 ¹ / ₂	4 ¹ / ₂	9 ¹ / ₄	60°
ATGI ^{1, 2}	15	1	1	6 ¹ / ₄	18 ³ / ₄	20 ³ / ₄	5	1 ¹ / ₂	3 ¹ / ₂	4 ¹ / ₂	9 ¹ / ₄	30°
FG	16	1 ¹ / ₈	1 ¹ / ₈	7	27 ⁵ / ₈	29 ⁷ / ₈	6 ¹ / ₄	1 ³ / ₄	4 ¹ / ₂	5 ³ / ₄	10 ¹ / ₄	60°
FGI ¹	16	1 ¹ / ₈	1 ¹ / ₈	7	27 ⁵ / ₈	29 ⁷ / ₈	6 ¹ / ₄	1 ³ / ₄	4 ¹ / ₂	5 ³ / ₄	10 ¹ / ₄	30°
FTG ³	17 ⁵ / ₈	1 ¹ / ₈	1 ¹ / ₈	7 ³ / ₈	27 ⁵ / ₈	29 ⁷ / ₈	6 ¹ / ₄	1 ³ / ₄	4 ¹ / ₂	5 ³ / ₄	10 ⁵ / ₈	60°
FTGI ^{1, 3}	17 ⁵ / ₈	1 ¹ / ₈	1 ¹ / ₈	7 ³ / ₈	27 ⁵ / ₈	29 ⁷ / ₈	6 ¹ / ₄	1 ³ / ₄	4 ¹ / ₂	5 ³ / ₄	10 ⁵ / ₈	30°
ZG-4 ¹ / ₂ ⁴ , ZG-6 ⁵	25	1 ¹³ / ₁₆	1 ¹¹ / ₁₆	8 ¹ / ₄	33 ⁵ / ₈	36 ¹ / ₈	6 ¹ / ₈	1 ¹¹ / ₁₆	4 ⁷ / ₁₆	6 ¹ / ₈	12 ⁷ / ₈	60°
WG-9, WG-13 WG-11, WG-15	30	2 ¹ / ₈	1 ⁵ / ₈	9 ¹ / ₈	33 ⁵ / ₈	41 ³ / ₈	6 ³ / ₈	1 ³ / ₄	4 ⁵ / ₈	13 ¹ / ₂	14 ⁵ / ₈	60°

¹Double Pawls — can be operated with half strokes of lever for use in close quarters.
²Convertible model — 1 chain 3/4 ton, 112" lift. 2 chains 1 1/2 tons, 57" lift.
³Convertible model — 1 chain 1 1/2 tons, 112" lift. 2 chains 3 tons, 57" lift.
⁴Convertible model — 2 chain 3 tons, 76" lift. 3 chains 4 1/2 tons, 51" lift.
⁵Convertible model — 3 chain 4 1/2 tons, 70" lift. 4 chains 6 tons, 53" lift.
 All dimensions are in inches unless otherwise indicated.

**Minimum stroke on double locking pawl models (AGI, ATGI, FGI, FTGI) one-half (30°) that of single locking pawl models (AG, ATG, FG, FTG). Where clearance dimensions are critical, request certified print.